

ERGO CUT S 105

P L A S M A R A N G E

TECHNICAL DATA

Voltage class	M
Standard length m	6
Air consumption	180 l/min
Air pressure	5 bar
Duty cycle 60%	100 A
Duty cycle 100%	70 A

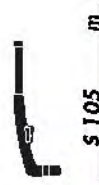
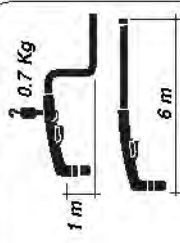

FITTING PA1654 6

FITTING PA1652 6

Central
adapters

DECLARATION OF CONFORMITY

The undersigned company Trafimet - Via del Lavoro, 8 - 36020 Castegnero (VI) - Italy - declares that the product identified and described on this page complies with standard EN 60974-7 in accordance with the requirements contemplated by directive EEC 73/23 low voltage.



EN 60974-7

trafimet[®]
your welding partner

ERGOCUT S 105

P L A S M A R A N G E

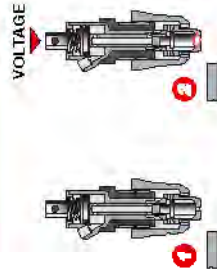

1 Torch off.

- By pressing the trigger the torch will be fed by the current thus causing a temporary short circuit between electrode and tip.
- The air then pushes up the small piston, thus creating, between the electrode and the tip, the distance needed to strike the pilot arc.
- By positioning the torch on the part to be cut, the plasma arc will strike.

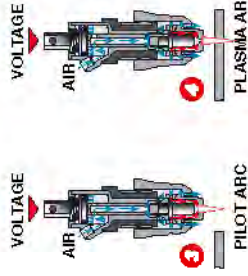

VOLTAGE

AIR

PILOT ARC

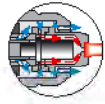

FLOWMETER

you have to do the airflow test before welding

MAX

MIN

PD0119-12

- By positioning the torch on the part to be cut, the plasma arc will strike.

COOLING AIR
CUT AIR



FH0820



PR0120

PE0112



PD0122-12



PC0119



CV0009

CV0021

CV0012

CV0011

CV0014

CV0012

CV0011

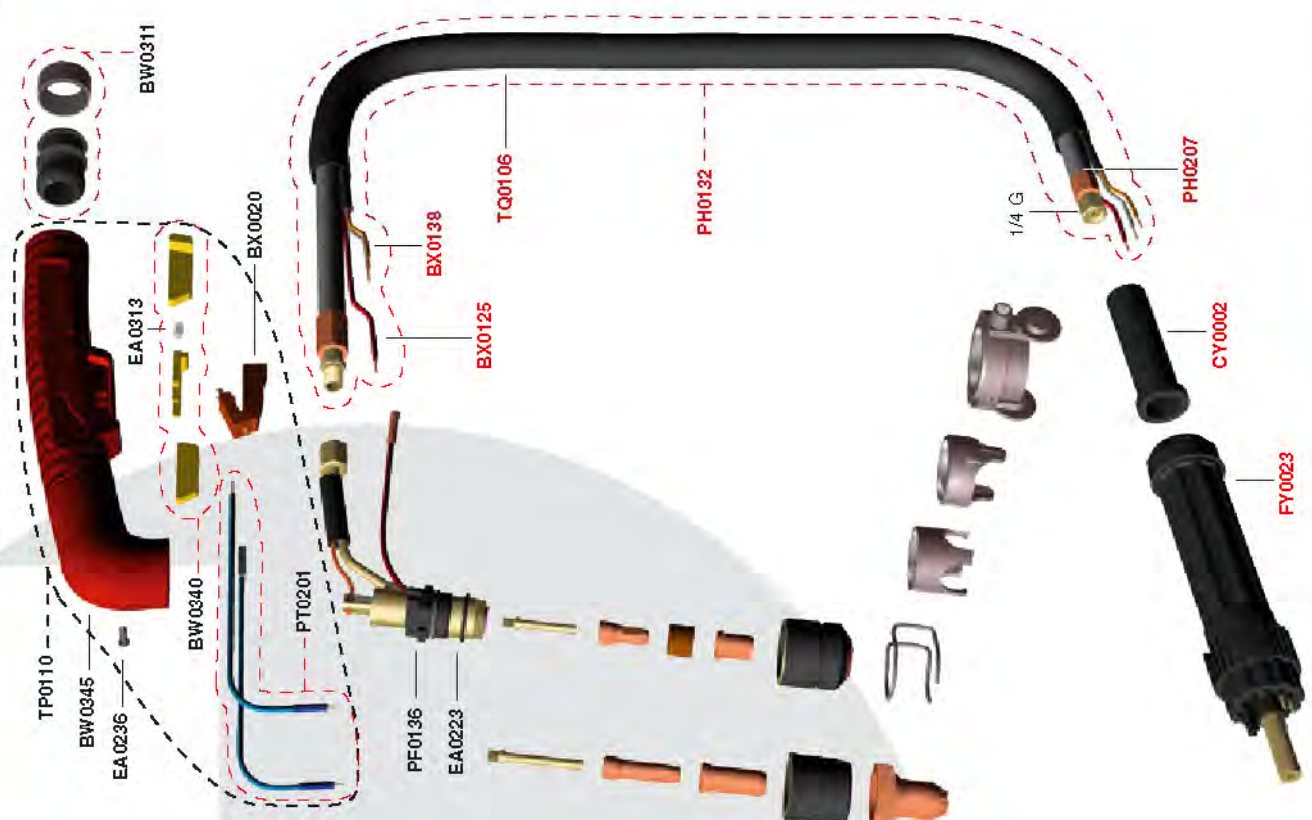

PLASMATOORTS ERGOCUT S 105

Leverancier	artikelnummer Tramex	Omschrijving	Type
PA1654	2512630151	Plasma snijtoorts 6 mtr.	Ergocut S 105 1/4G
PA1652	2512630150	Plasma snijtoorts 6 mtr.	Ergocut S 105 C.A.
FH0647	2522632153	Luchtgeleidingsbuisje	S75+S105
PR0117	2522632154	Snij-electrode	S75+S105
PE0112	2522632155	Luchtverdeler	S75+S105
PD0119-12	2522632606	Snijmondstuk 1,2 MM	S 105
PD0119-14	2522632607	Snijmondstuk 1,4 MM	S 105
PC0118	2522632608	Gasmondstuk	S 105
CV0011	2522632312	Afstandsveer	Diverse toortsen
CV0014	2522632314	Afstandsbus 4-poots	A101+A141+A151+PW180
CV0012	2522632313	Afstandsbus 2-poots	Diverse toortsen
CV0021	2522632321	Snijwagen	Diverse toortsen
FH0820	2522632641	Luchtgeleidingsbuisje	S 105
PR0120	2522632643	Elektrode lang	S 105
PE0112	2522632155	Luchtverdeler	S75+S105
PD0122-12	2522632642	Snijmondstuk lang	S 105
CV0009	2522632349	Afst.cup-kontaktsnijden	A101+A141+A151
TP0110	2522632240	Handgreep Kpl.	A81+A101+A141+A151
BW0345	2522632243	Handgreep, los	A81+A101+A141+A151
EA0236	2522632064	Inzetschroeven handgreep	Diverse plasma
BW0340	2522632213	Beveiliging tbv schakelaa	A81+A101+A141+A151
BX0020	2162609021	Drukschakelaar	Diverse toortsen
EA0313	2522632214	Veer	Diverse plasma
BW0311	2342640210	Kogelgewricht + ring	Diverse toortsen
PF0136	2522632601	Branderlichaam	S 105
EA0223	2522632152	O-ring	S75+S105
BX0125	2552650298	Kabelpilotboog	CB 50
BX0138	2522632079	Controle kabel	S 45
TQ0106	2582650777	Beschermhoes 20x22	HY100
PH0132	2522632234	Toortspakket 6M 1/4 G	Ergocut A81
PH0207	2522632210	Stroomluchtkabel 6M	A81 1/4G
CY0002	2162609726	Buigbescherming	Diverse toortsen
FY0023	2522632130	C.A. 5-pins Kpl. T.Z.	Diverse plasma
CV0088	2522632355	Flowmeter	A101+CB100
CV0022	* 2522632322	Snijwagen-passer-set	Diverse toortsen

* = niet afgebeeld.